

# SUNSET R130



## ΠΕΡΙΕΧΟΜΕΝΑ / CONTENTS

datasheet	1
manual	2

## ΚΩΔΙΚΟΣ / CODE

SUN130- XX-XX-XX-XX-XX-XX-XX

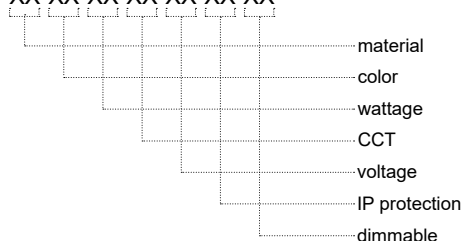

## SUNSET R130 (SUN130) / Datasheet

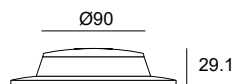
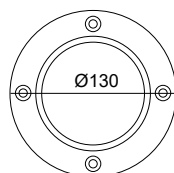

### General information

Application	Outdoor / Surface mounted
Direction of mounting	Ground
LED	Cree / Osram
Life time	50000 hrs
Warranty	3-5 years (*5 years upon request)
Origin	Greece
Visible dimensions (Ø×L)	Ø130 × 29.1 mm

Material	Color	Wattage	CCT	Voltage	IP	Dimmable
Aluminium (01)	Anodised (AN)	0.5W (05W)	2700K (27K)	12VDC (V1)	IP20 (20)	Yes (D)
Inox (02)	Black (BL)	1W (1W)	3000K (30K)	24VDC (V2)	IP54 (54)	No (L)
Brass (03)	White (WH)	2W (2W)	4000K (40K)	230VAC (V3)	IP65 (65)	
	RAL colors (RL)	2.5W (25W)	5000K (50K)	12/24V (V4)	IP67 (65)	
		3W (3W)	6000K (60K)	350mA (V5)		
		4W (3W)	(R)/(G)/(B)/(A)	500mA (V6)		
			RGB (C1)			

Δημιουργία Κωδικού προϊόντος / Product Code generator

**SUN130 - material - color - wattage - CCT - voltage - IP - dimmable**

(ex. SUN130-01-AN-1W-27K-V1-54-D for Sunset R130 Aluminium Anodised 1W 2700K 12VDC IP54 Dimmable)

## SUNSET R130 / Manual

1.

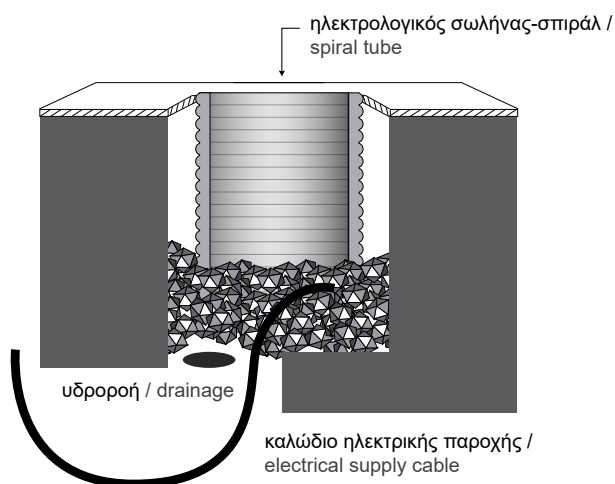

2.

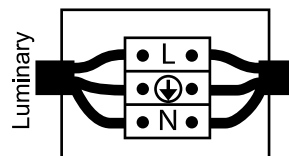

Συνδέστε το καλώδιο του φωτιστικού με την ηλεκτρική παροχή. Η σύνδεση πρέπει να είναι στεγανή. / Connect the cable of the luminaire with the electrical supply. The connection must be sealed.

3. Εφαρμογή στο έδαφος με βίδωμα / Application on ground using screws

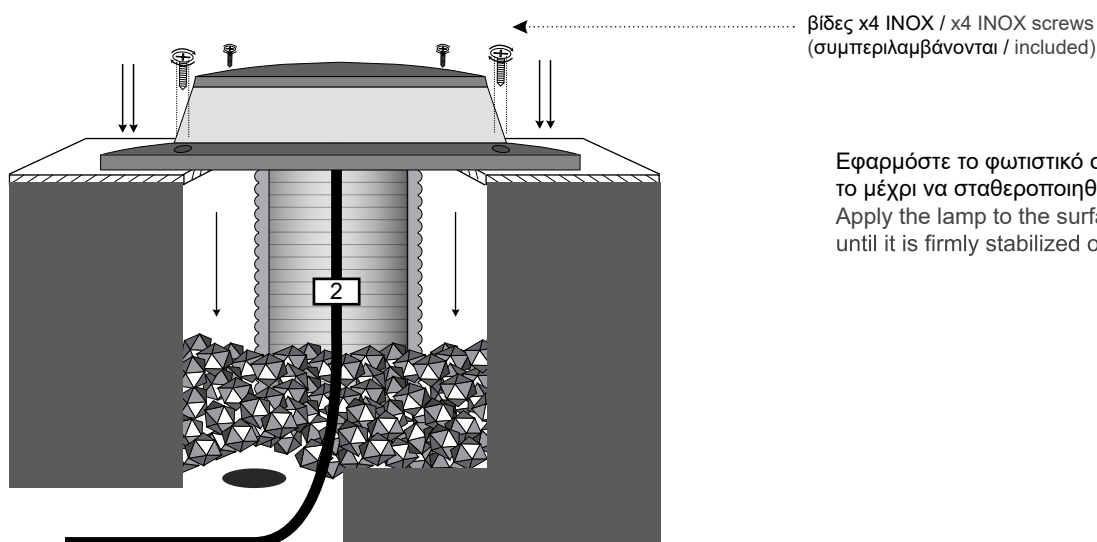

Εφαρμόστε το φωτιστικό στην επιφάνεια και βιδώστε το μέχρι να σταθεροποιηθεί στο έδαφος. / Apply the lamp to the surface and tighten the screws in until it is firmly stabilized on the ground.